



Key Features

- **High expandability**

Up to 20 Door Stations, 32 IP cameras and 5 Room Monitors can be connected.

- **PoE support**

The Door Station and Room Monitor support PoE (IEEE 802.3af compliant, class 2 device). A power supply unit is also available (VL-PS240 is sold separately).

- **Card reader**

The Door Station has an RFID reader that can be used to unlock the electric lock. Up to 10,000 cards can be recorded.

- **Electric lock release support***

The electric lock can be easily and quickly released from the Room Monitors and the card reader on the Door Stations. *Optional relay box (VL-RLY1) is required.

- **Picture recording / FTP uploading**** ** Consult Panasonic for FTP server setting.

Up to 100 images can be recorded to the Room Monitor. Images can also be automatically uploaded to an FTP server when a visitor calls from a Door Station.

- **7-inch touch screen**

The Room Monitor has a 7-inch wide LCD that clearly shows each visitor's face, and the touch screen provides an easy-to-use operation screen.

- **High-resolution camera, Night Vision with LED lights :**

The Door Station has a 1.3 M pixel camera that provides a clear image with a wide view of 113° (horizontal), 69° (vertical). You can check visitors even when it's dark outside.

Maximum System Configuration

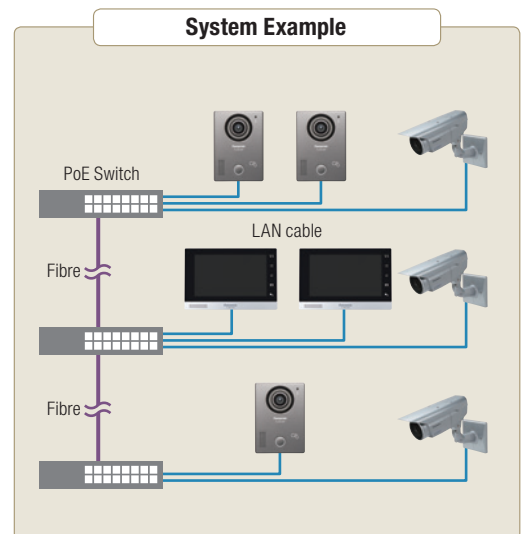
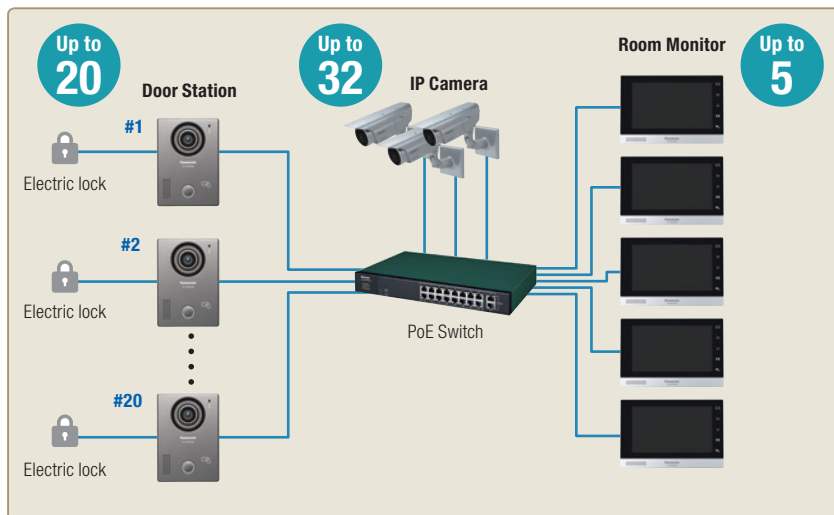

Wiring Schematic Diagram

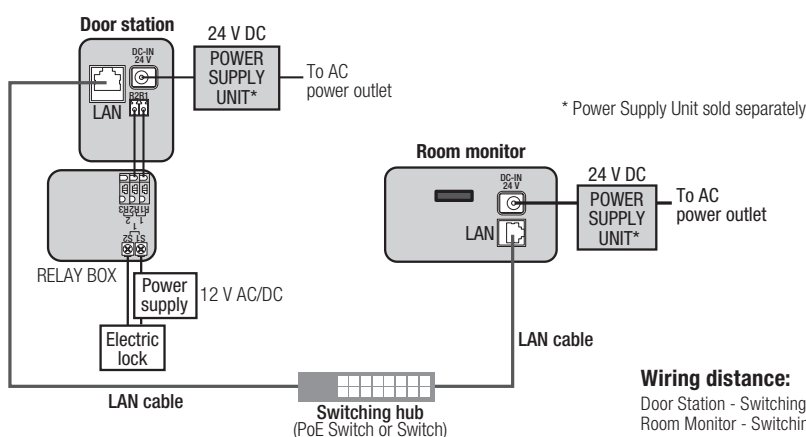

IP Camera Integration

- **Operation Specification**

- Codec Format: H.264 (Fixed)
- Image Resolution: 720p (1280x720 pixels) or less
- Frame Rate: 20 fps or less

- **Recommended Models**

- E-series
- iPRO

The Installation Guide is available at the following web site.

<https://panasonic.net/cns/pcc/support/intercom/mn1000/>

* The system setup/configuration shall be made by the installer.

Wiring distance:

Door Station - Switching hub: Up to 100 m (UTP Cat5e or higher)

Room Monitor - Switching hub: Up to 100 m (UTP Cat5e or higher)

Specifications

Model number	VL-VN1500 (Door Station)	VL-MN1000 (Room Monitor)	VL-PS240 (Power Supply Unit)	VL-RLY1 (Relay Box)
Dimensions (Unit: mm)				
Power source	PoE (IEEE 802.3af compliant, Class 2 device) or Power supply unit (VL-PS240*) 24 V DC, 0.6 A	PoE (IEEE 802.3af compliant, Class 2 device) or Power supply unit (VL-PS240*) 24 V DC, 0.6 A	Input: 220-240 V AC, 0.2 A (50/60 Hz) Output: 24 V DC, 0.6 A	Supplied by the main monitor
Power consumption	PoE: Standby: 2.5 W, Operating: 5.1 W VL-PS240: Standby: 2.6 W, Operating: 6.3 W	PoE: Standby: 1.9 W, Operating: 6.3 W VL-PS240: Standby: 2.1 W, Operating: 6.2 W	-	-
Dimensions (H x W x D) (Excluding protruding sections)	141 x 100 x 28.5 mm	137.5 x 205 x 27.8 mm	116 x 100 x 54 mm	92 x 78 x 38 mm
Weight	250 g	550 g	230 g	130 g
Operating environment	Ambient temperature: Approx. -10 °C to +55 °C Relative humidity (non-condensing): up to 90 %	Ambient temperature: Approx. 0 °C to +40 °C Relative humidity (non-condensing): up to 90 %	Ambient temperature: Approx. 0 °C to +50 °C Relative humidity (non-condensing): up to 90 % (indoor use only)	Ambient temperature: Approx. 0 °C to +40 °C Relative humidity (non-condensing): up to 90 %
Display	-	7-inch wide colour display with touch screen (800x480 pixels)	-	-
Display language	-	English, Arabic, French, Italian, German, Spanish and Dutch	-	-
Talking method	Hands-free	Hands-free	-	-
Network interface	10BASE-T/100BASE-TX (Auto MDI/MDI-X)	10BASE-T/100BASE-TX (Auto MDI/MDI-X)	-	-
Network protocol	TCP/IP, UDP	TCP/IP, UDP	-	-
Wiring	UTP (cat.5e or higher)	UTP (cat.5e or higher)	-	-
Card reader (RFID)	13.56 MHz (ISO/IEC 14443 Type A (MIFARE))	-	-	-
Expanded interface	E-lock x 1 *Relay box VL-RLY1 is required (sold separately)	Sensor input x 5 (including emergency / urgency button)	-	-
Viewing angle	Horizontally: Approx. 113°, Vertically: Approx. 69°	-	-	-
Image sensor	1.3 M pixel CMOS sensor	-	-	-
Minimum illuminance required	1 lx (within approx. 50 cm from the camera lens)	-	-	-
Lighting method	White coloured LED lights	-	-	-
Video / Audio format	Video: H.264, Audio: G.711	Video: H.264, Audio: G.711	-	-
Recording	-	Internal memory (video with audio can be saved)	-	-
IP rating / IK rating	IP54 ² / -	-	-	-
Installation method	Surface mount (mounting base supplied)	Surface mount (mounting bracket supplied) or Flush mount (mounting box VL-VN1790 sold separately)	Wall mount or attach to DIN rail	Wall mount or attach to DIN rail
External material	PC+ABS resin	PC+ABS resin	Flame retardant PC+ABS resin	Flame retardant ABS resin

*1 VL-PS240 is sold separately.

*2 Water resistance is only assured if the Door Station is installed correctly according to the instructions in the Installation Guide, and appropriate water protection measures are taken.

Installing the Door Station

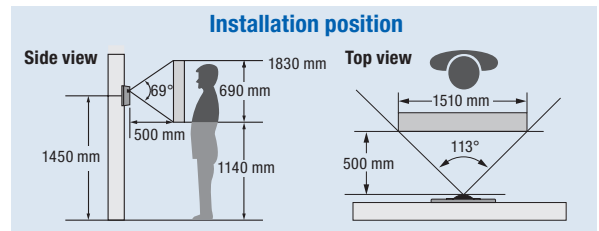
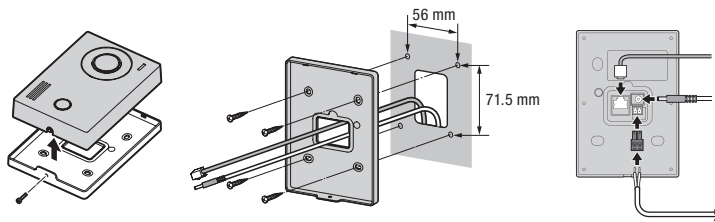

Installing the Room Monitor

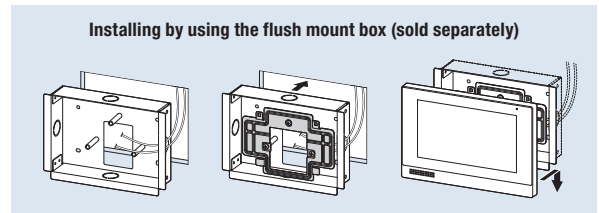
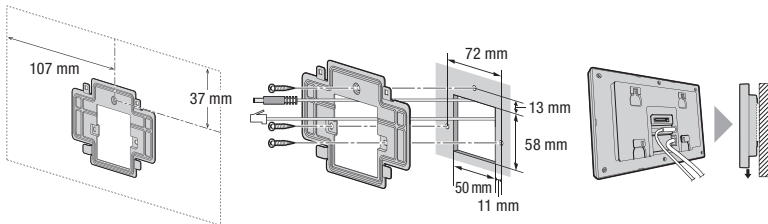

Installing the Power Supply Unit

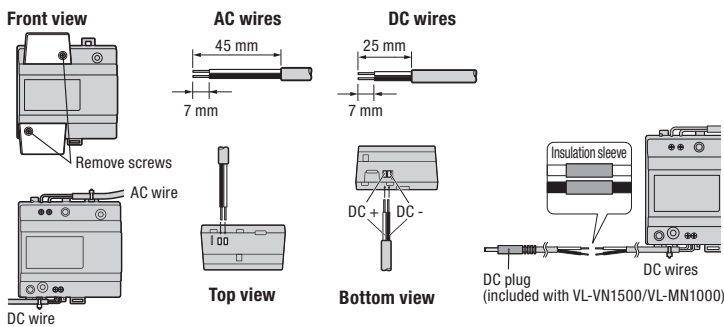

Important

- Safety Precaution: carefully read the operating instructions and installation manual before using this product.
- Panasonic cannot be responsible for the performance of the network and/or other manufactures' products used on the network.

Installing the relay Box

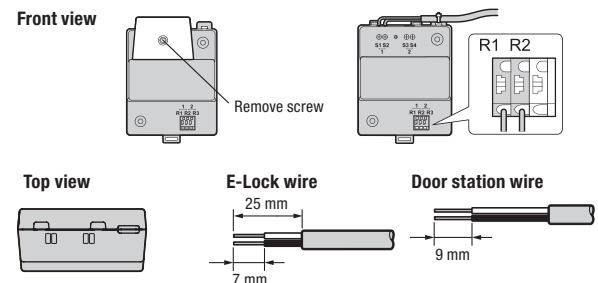

- The actual product may vary slightly from photograph.
- Weights and dimensions are approximate.
- Design and Specifications are subject to change without notice.
- These products may be subject to export control regulations.

DISTRIBUTED BY :

Panasonic[®]